



CREEKSIDE



MEMBER APPRECIATION WEEKEND

6305 West 6th Avenue
Lakewood, CO 80214

303.232.6272
Fax: 303.232.0150

7 Indoor Heated Tennis
Courts

3 Outdoor Courts

3 Social Lounges:
▪ I with Tennis Viewing
▪ I with Fireplace
▪ I Outdoor Relaxation
area with Fireplace

Fully Equipped Resistance
Training Room

Cardio Equipment Room

Senior Fitness and
Silver Sneakers Classes

Tennis Pro Shop:
▪ Shoes
▪ Racquets
▪ Gifts & Accessories

www.MeadowCreekTennis.com
info@meadowcreektennis.com



Our annual **Club Championship & Member Appreciation weekend** is almost here! Join us on **February 9th & 10th** for this “member only” event. There will be prizes, parties, priceless fun and plenty of tennis all weekend long. The usual bragging rights are on the line for 2019 and you won’t want to miss your opportunity to get your name displayed on our infamous “Wall of Fame!” **Don’t have a partner? Let us help find you one!** The best part is you don’t have to play in the tournament to enjoy all the festivities! Just drop by anytime during the weekend to enjoy food, friends and camaraderie as you cheer on your fellow Meadow Creek Members.

- Men’s & Women’s 3.0/3.5/4.0 and 4.5+ singles and doubles
- Mixed combined level 6.0/7.0/8.0 and 9.0+
- Any Adult team may consist of 1 High School player
- High School Girls and High School Boys division, Singles only
- Men’s & Women’s doubles will have a maximum 9.5 combined rating for the 4.5+ division
- Tournament is open to all Members and Employees
- You must play at your 2019 NTRP published rating or above
- Participants are limited to playing in 2 events
- Entry cut-off will be Wednesday, February 6th
- Tournament draws will be posted Thursday, February 7th
- This is a non-sanctioned tournament



\$22 per singles event \$15 per person for doubles



MEADOW CREEK
**CLUB
CHAMPIONSHIP**
& MEMBER APPRECIATION WEEKEND
FEBRUARY 9 & 10

Saturday Morning:
Matches start at 8am
Continental Breakfast
will be served followed
by lunch and snacks in
the afternoon

Saturday Evening:
Player Party!
Food & Drinks
served

Sunday Morning:
Matches will start at 8am
Continental Breakfast will
be served followed by lunch
in the afternoon

JUNIOR TEAM TENNIS



The time to start thinking about Junior Team Tennis is NOW!

Contact Stanley at sroffe@meadowcreektennis.com with any questions, or call 303.232.6272 to get registered

Don't delay, get your Summer plans nailed down now!



Meadow Creek's JTT program runs from the end of May until the end of July. This Summer program is for players 10-18 years old. It is open to Orange/Green/Yellow Ball players. Matches are played on Mondays, with practices on Wednesdays and Fridays here at Meadow Creek. Your child has the opportunity to be part of a team and play other junior players from Denver Metro area clubs.

Teams are comprised of similar age, gender, and skill level players. JTT offers four age divisions: 10 & under, 12 & under, 14 & under, 18 & under. Within these age divisions, there are 3 levels: Beginners (Futures), Intermediate (Challenger), and Advanced (Championship). We will evaluate your child and place them in the appropriate level in effort to provide the best possible experience in terms of both competition and fun!

Teams are forming now! Feel free to bring a team of your friends/teammates, or we will place you on a team. Either way, it's a fantastic way to test your skills and get accustomed to real-life match play!

PADDLE TENNIS

If you haven't been part of the commotion in Meadow Creek's backyard, you don't know what you are missing out on. Our paddle (aka platform) tennis season is at its peak right now, and these folks are having a ball! Playing paddle tennis in the winter provides a unique experience. The elevated court allows the heaters underneath to melt the snow and ice. Just like tennis, paddle tennis will give you a lot of physical benefits such as improving your cardiovascular health, enhance your overall endurance, and build strength across multiple muscle groups. Here at Meadow Creek, we offer paddle leagues Monday thru Thursday evenings. As a reminder, your Full-Facility Tennis Membership allows you to play paddle at hourly Member rates. Paddle-Plus Members receive unlimited court time year-round.

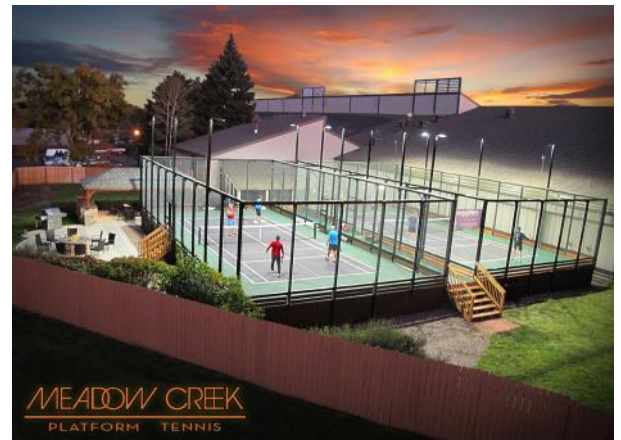

If you would like to get involved with paddle, have any paddle questions, or would like to be included in our paddle eBlasts, please email Laura James at paddle@meadowcreektennis.com.

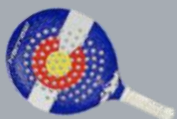

\$20 FIRST PADDLE LESSON

All Members & Guests will receive their first lesson with Brock Borman for only \$20
Everyone is eligible, whether they are a beginner or an experienced paddle player

HAPPENINGS AT MEADOW CREEK

Are you ready to up the ante in your game to be ready for the start of leagues? Here at Meadow Creek we are "All In!"

SPRING ACE IT



Our new **Spring Ace-It** clinic is not here to trump our Fall Fix-It program, but rather to follow suit (and we're not bluffing!) For 6 weeks this Spring, you call the shots! We will customize your clinic to fit your needs. Tell us what's lacking in your hand, for example:

- ◆ Looking for strategies to deal with the chronic poacher?
- ◆ Are your overheads a little too wild?
- ◆ Does your doubles strategy get trumped easily?
- ◆ Puzzled on what to do with that annoying lobber across the court?
- ◆ Do you just want to hit piles of balls to dial-in your stroke?

The answer to these and just about any other bad hand can be dealt with in our **Spring Ace-It** clinic. Clinics start the week of March 10th and end just before the USTA 18+ league kicks off. Register individually, as a doubles-duo, or bring your entire team to Meadow Creek for this "must have" ace-in-the-hole clinic! We will shuffle things around to find a time and a pro to work with you and/or your group. (6 weeks, 90 minutes/week)

Email rlacjak@meadowcreektennis.com to register, call 303.232.6272 x16



We are offering 4 formats for our Spring Ace-It clinics:

4:1 (4 players : 1 pro)
\$180/Members; \$213/NM

6:1 (6 players : 1 Pro)
\$120/Members; \$142/NM

8:2 (8 players : 2 Pros)
\$180/Members; \$213/NM

12:2 (12 players : 2 Pros)
\$120/Members; \$142/NM

Valentine's Social



Join us for a night of Mixed Doubles with or without your sweetie! This is a potluck social so bring a dish or drink to share.

Friday, February 15th 6:30pm-9pm
\$18/Members \$22/Non-Members

FEBRUARY FLING INDOOR DOUBLES PICKLEBALL TOURNAMENT

Friday/Saturday/Sunday

February 15 - 17, 2019

Men's & Women's Doubles Divisions (3.0-4.5)
Mixed Doubles Divisions (3.0-4.5)

To register call 303.232.6272 or email jstokes@meadowcreektennis.com. Visit our website for more detailed information and a registration form: www.MeadowCreekTennis.com

Meadow Creek Junior Open Championship February 28 - March 6

Boys & Girls Singles
Ages 12-18 Yellow Ball
Designated Level 6



Register on Tennislink
#257210719
entries close Thursday, February 21

USTA & CTA LEAGUE UPDATES

We are currently forming our 2019 Spring/Summer USTA and CTA leagues. If you had a team that played out of Meadow Creek last year, you will get registration priority. Captains, please contact Jaime to reserve your team number. If you are interested in joining a team, Jaime can also help with that as well. Call her at 303.232.6272 x18 or email to jstokes@meadowcreektennis.com.

The CTA & USTA made a few changes for the upcoming season. Notably, play-days for some levels have changed in a number of leagues. Highlighted in red below are the changes. If your level is in black, or the league is not listed below, the day of the week you play remains the same as 2018. The changes are as follows:

2019 Denver-Metro League Changes in RED				
League (All Matches at 6pm)	Monday	Tuesday	Wednesday	Thursday
USTA Adult 18 & Over April 22 - June 6	W 3.0 M 3.0	W 4.0 & 4.5 M 3.5	W 2.5 & 5.0+ M 4.0	W 3.5 M 4.5 & 5.0+
USTA Adult 40 & Over June 10 - July 25	W 4.0 M 4.0 & 4.5+	W 3.0 & 4.5+ M 3.0	W 2.5 M 3.5	W 3.5
CTA Twilight July 29 - September 12	W 3.5 & 4.5 M 3.0	W 5.0+ M 3.5, 4.0 & 4.5+	W 3.0	W 2.5 & 4.0



Coman Tiebreak Procedure Change

The Coman tiebreak procedure will no longer be used for any league matches in Colorado. Instead, all set tiebreaks and match tiebreaks in local leagues and district championship matches will be played using the standard tiebreak (play 6 points on a side and then switch sides, all the other rules remain the same.) The Coman tiebreak will still be in effect at Sectional and National Championships, however.

New "Plus" Divisions Added to CTA Leagues

Straight NTRP "CTA" leagues will now offer "plus levels." The highest offered NTRP level at District Championships will be designated as the plus (+) NTRP level. This can differ for the men's & women's divisions. Since all CTA leagues are 3-line leagues, teams participating in designated plus (+) divisions will be able to have two players on their roster from the next higher NTRP rating level (only one can play in each team match). Adding plus (+) divisions will give players the opportunity to play in leagues they would otherwise be excluded from.

Seeding for Final Rounds at District Championships

Consistent with USTA National, Semi-final rounds at District Championship events will now be seeded. The match ups for the semi-final rounds will be as follows: 1 vs 4 and 2 vs 3. League seeding will only take place at semi-final rounds of District Championships. In situations where a wildcard team advances to the semis, it is possible that teams from the same flight could play each other again in the semis.

ITA Mixed Rescheduling of Matches Change

Teams participating in ITA Mixed matches will no longer be able to request to reschedule their match due to a league championship conflict. This change is only for the ITA Mixed League since the majority of the league season takes place on dates with league championship events. Since ITA Mixed matches are played on Sunday at 12pm and 3pm, this should minimally affect players playing in league championships.

MEADOW CREEK

TENNIS & FITNESS CLUB

Monday to Thursday 6am - 10pm
Friday 6am - 9pm • Weekends 8am - 8pm
6305 West 6th Avenue, Lakewood, Colorado 80214
Phone: 303.232.6272 • Fax: 303.232.0150
www.MeadowCreekTennis.com